

31-DEC-2014 12:01  
 C:\div8\_projects\rdy\HOKE\nc40\sr\_1305(wayside\_r.d)\psh\combined\_t.sh.dgn  
 OS-davis AT D8CAD-270410

**TIP PROJECT: SS-4908AI - W-5208J - W-5601I PROJECTS: US 401**

See Sheet 1-A For Index of Sheets  
 See Sheet 2 For Conventional Symbols

# STATE OF NORTH CAROLINA

## DIVISION OF HIGHWAYS

---

# HOKE COUNTY

STATE	STATE PROJECT REFERENCE NO.	SHEET NO.	TOTAL SHEETS
N.C.	SS-4908AI - W-5208J W-5601I	1	
WBS ELEMENT	F.A. PROJ. NO.	DESCRIPTION	
SS-4908AI 43574.3.1		CONST.	
W-5208J 45338.3.FS10	HSIP-0401(254)	CONST.	
W-5601I 50138.3.FS7	HSIP-0401(263)	CONST.	

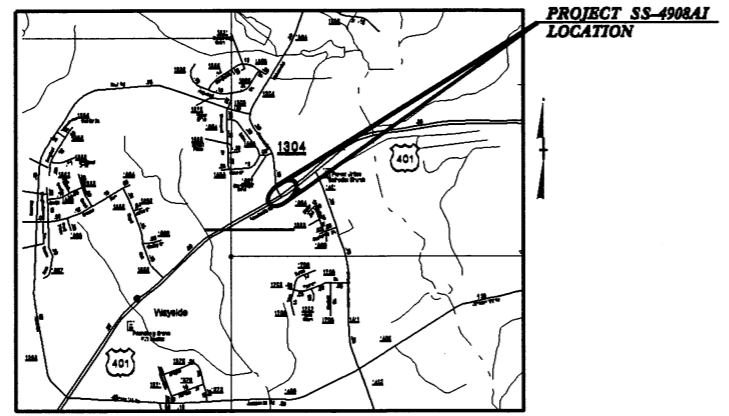

**PART I: PROJECT SS-4908AI**  
**LOCATION: US 401 AT SR 1304 (HOBSON RD.)**  
**TYPE OF WORK: GRADING, PAVING, DRAINAGE, CONCRETE ISLANDS, AND THERMOPLASTIC MARKINGS & MARKERS**

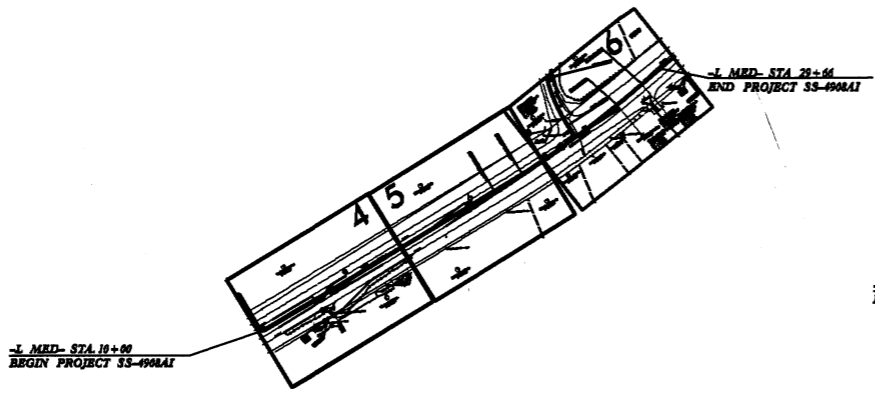

**PART II: PROJECT W-5208J**  
**LOCATION: US 401 AT SR 1305 (WAYSIDE RD.) AND SR 1418 (LINDSAY RD)**  
**TYPE OF WORK: GRADING, PAVING, DRAINAGE, CONCRETE ISLANDS, SIGNAL AND THERMOPLASTIC MARKINGS & MARKERS**

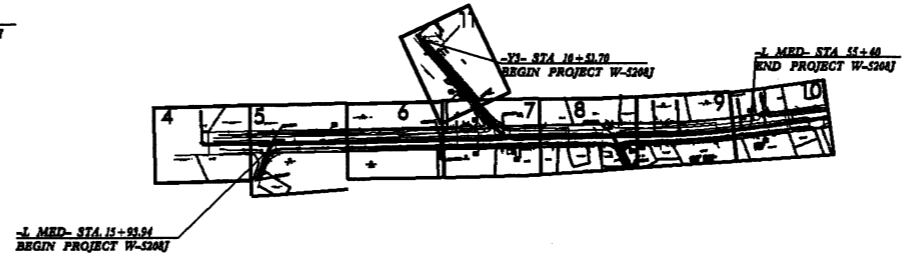
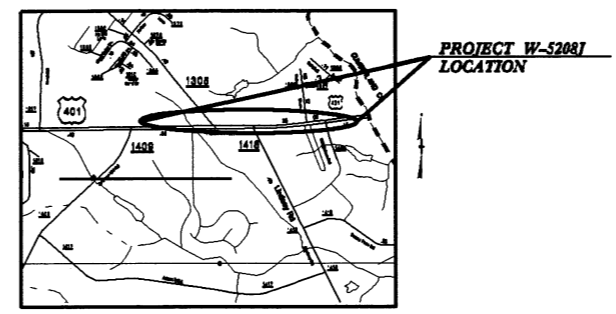

**PART III: PROJECT W-5601I**  
**LOCATION: US 401 AT SR 1405 (N. MAIN ST.)**  
**TYPE OF WORK: GRADING, PAVING, DRAINAGE, CONCRETE ISLANDS, AND THERMOPLASTIC MARKINGS & MARKERS**

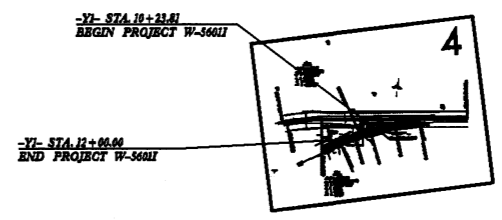
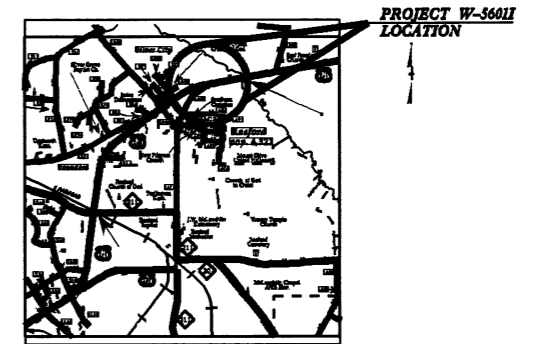

VICINITY MAP

PROJECT LENGTH	
LENGTH ROADWAY PROJ. SS-4908AI	0.37 MILES
LENGTH ROADWAY PROJ. W-5208J	0.93 MILES
LENGTH ROADWAY PROJ. W-5601I	0.01 MILES
TOTAL: 1.31 MILES	

Prepared in the Office of:  
**DIVISION OF HIGHWAYS**

**DIVISION 8**  
**DESIGN & CONSTRUCT UNIT**  
 902 N. SANDHILLS BLVD.  
 ABERDEEN NC 28315

**DIVISION OF HIGHWAYS**

2012 STANDARD SPECIFICATIONS

RIGHT OF WAY DATE: \_\_\_\_\_

LETTING DATE: \_\_\_\_\_



DIVISION DESIGN &  
 CONSTRUCT ENGINEER

12-31-14

*Greg S. Davis* P.E.

SIGNATURE:

DIVISION DESIGN &  
 CONSTRUCT ENGINEER

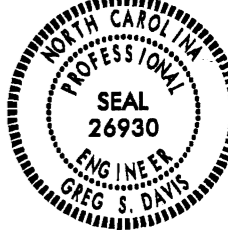

PROJECT REFERENCE NO. SS-4908AJ, W-5208J W-5601I	SHEET NO. 1-A
--	------------------

*gso*  
12-31-19



DIVISION DESIGN / CONSTRUCT ENGINEER

GENERAL NOTES

GRADING AND SURFACING OR RESURFACING AND WIDENING:

THE GRADE LINES SHOWN DENOTE THE FINISHED ELEVATION OF THE PROPOSED SURFACING AT GRADE POINTS SHOWN ON THE TYPICAL SECTIONS. WHERE NO GRADE LINES ARE SHOWN, THE PROFILES SHOWN DENOTE THE TOP ELEVATION OF THE EXISTING PAVEMENT ALONG THE CENTER LINE OF SURVEY ON WHICH THE PROPOSED RESURFACING WILL BE PLACED. GRADE LINES MAY BE ADJUSTED BY THE ENGINEER IN ORDER TO SECURE THE PROPER TIE-IN.

CLEARING

CLEARING ON THIS PROJECT SHALL BE PERFORMED TO THE LIMITS ESTABLISHED BY METHOD III.

SHOULDER CONSTRUCTION:

ASPHALT, EARTH, AND CONCRETE SHOULDER CONSTRUCTION ON THE HIGH SIDE OF SUPERELEVATED CURVES SHALL BE IN ACCORDANCE WITH STD. NO. 560.01.

UTILITIES

ANY RELOCATION OF EXISTING UTILITIES EXCEPT AS NOTED IN PLANS, WILL BE ACCOMPLISHED BY OTHERS PRIOR TO THE DATE OF AVAILABILITY.

INDEX OF SHEETS

SHEET NUMBER	SHEET
1	TITLE SHEET (PART I & PART II)
1-A	INDEX OF SHEETS
2	CONVENTIONAL SYMBOLS
3 THRU 3A	SUMMARY OF QUANTITIES

PART I : SS-4908AJ

1	TITLE SHEET
2 THRU 2-C	TYPICAL SECTIONS
3	SUMMARY OF EARTHWORKS, ETC.
3-A	DRAINAGE SUMMARY
4 THRU 6	PLAN SHEETS
PMP-1 THRU PMP-3	PAVEMENT MARKING PLANS
ECP-1 THRU ECP-5	EROSION CONTROL PLANS
X-A	CROSS-SECTION SUMMARY
X-1 THRU X-12	CROSS-SECTIONS -L MED-

PART II : W-5208J

1	TITLE SHEET
2 THRU 2-G	TYPICAL SECTIONS
2-H	DETAIL - RELOCATION OF 8" WATER PIPE AT PROP. STORM DRAINAGE
3	SUMMARY OF EARTHWORKS, ETC.
3-A	DRAINAGE SUMMARY
4 THRU 11	PLAN SHEETS
PMP-1 THRU PMP-7	PAVEMENT MARKING PLANS
SIG-1 THRU SIG-4	SIGNAL PLANS
ECP-1 THRU ECP-10	EROSION CONTROL PLANS
X-A	CROSS-SECTION SUMMARY
X-1 THRU X-45	CROSS-SECTIONS -L MED-
X-46 THRU X-57	CROSS-SECTIONS -Y3-

PART III : W-5601C

1	TITLE SHEET
2	TYPICAL SECTIONS
3	SUMMARY OF EARTHWORKS, ETC.
3-A	DRAINAGE SUMMARY
4	PLAN SHEETS
PMP-1	PAVEMENT MARKING PLANS
ECP-1 THRU ECP-4	EROSION CONTROL PLANS
X-A	CROSS-SECTION SUMMARY
X-1 THRU X-3	CROSS-SECTIONS -EL-
X-4 THRU X-7	CROSS-SECTIONS -Y1-

2012 ROADWAY ENGLISH STANDARD DRAWINGS

The following Roadway Standards as appear in "Roadway Standard Drawings" Highway Design Branch - N. C. Department of Transportation - Raleigh, N. C., Dated January 17, 2012 are applicable to this project and by reference hereby are considered a part of these plans:

STD.NO.	TITLE
225.01	Guide for Grading Subgrade - Interstate and Freeway
225.05	Method of Obtaining Superelevation - Divided Highway
560.01	Method of Shoulder Construction - High Side of Superelevated Curve - Method I
560.02	Method of Shoulder Construction - High Side of Superelevated Curve - Method II
654.01	Pavement Repairs
840.14	Concrete Drop Inlet
840.22	Frames and Wide Slot Sag Grates
840.25	Anchorage for Frames - Brick, Concrete, or Precast
840.46	Traffic Bearing Drainage Structures
840.66	Drainage Structure Steps
852.01	Concrete Islands
852.04	Method for Placement of Drop Inlets in Grassed Median
852.01	Concrete Islands
852.06	Method for Placement of Drop Inlets in Concrete Islands
876.02	Guide for Rip Rap at Pipe Outlets

# CONVENTIONAL PLAN SHEET SYMBOLS

## BOUNDARIES AND PROPERTY:

State Line	-----
County Line	-----
Township Line	-----
City Line	-----
Reservation Line	-----
Property Line	-----
Existing Iron Pin	○ IP
Property Corner	-----
Property Monument	□ PM
Parcel/Sequence Number	②③
Existing Fence Line	-x-x-x-
Proposed Woven Wire Fence	○
Proposed Chain Link Fence	□
Proposed Barbed Wire Fence	◇
Existing Wetland Boundary	-----
Proposed Wetland Boundary	-----
Existing Endangered Animal Boundary	-----
Existing Endangered Plant Boundary	-----
Known Soil Contamination: Area or Site	☠
Potential Soil Contamination: Area or Site	☠

## BUILDINGS AND OTHER CULTURE:

Gas Pump Vent or U/G Tank Cap	○
Sign	○
Well	○
Small Mine	✕
Foundation	□
Area Outline	□
Cemetery	□
Building	□
School	□
Church	□
Dam	□

## HYDROLOGY:

Stream or Body of Water	-----
Hydro, Pool or Reservoir	-----
Jurisdictional Stream	-----
Buffer Zone 1	-----
Buffer Zone 2	-----
Flow Arrow	-----
Disappearing Stream	-----
Spring	○
Wetland	-----
Proposed Lateral, Tail, Head Ditch	-----
False Sump	-----

## RAILROADS:

Standard Gauge	-----
RR Signal Milepost	-----
Switch	-----
RR Abandoned	-----
RR Dismantled	-----

## RIGHT OF WAY:

Baseline Control Point	-----
Existing Right of Way Marker	-----
Existing Right of Way Line	-----
Proposed Right of Way Line	-----
Proposed Right of Way Line with Iron Pin and Cap Marker	-----
Proposed Right of Way Line with Concrete or Granite R/W Marker	-----
Proposed Control of Access Line with Concrete CA Marker	-----
Existing Control of Access	-----
Proposed Control of Access	-----
Existing Easement Line	-----
Proposed Temporary Construction Easement	-----
Proposed Temporary Drainage Easement	-----
Proposed Permanent Drainage Easement	-----
Proposed Permanent Drainage / Utility Easement	-----
Proposed Permanent Utility Easement	-----
Proposed Temporary Utility Easement	-----
Proposed Aerial Utility Easement	-----
Proposed Permanent Easement with Iron Pin and Cap Marker	-----

## ROADS AND RELATED FEATURES:

Existing Edge of Pavement	-----
Existing Curb	-----
Proposed Slope Stakes Cut	-----
Proposed Slope Stakes Fill	-----
Proposed Curb Ramp	-----
Existing Metal Guardrail	-----
Proposed Guardrail	-----
Existing Cable Guiderail	-----
Proposed Cable Guiderail	-----
Equality Symbol	-----
Pavement Removal	-----
VEGETATION:	
Single Tree	-----
Single Shrub	-----
Hedge	-----
Woods Line	-----

Orchard	-----
Vineyard	-----

## EXISTING STRUCTURES:

MAJOR:	
Bridge, Tunnel or Box Culvert	-----
Bridge Wing Wall, Head Wall and End Wall	-----
MINOR:	
Head and End Wall	-----
Pipe Culvert	-----
Footbridge	-----
Drainage Box: Catch Basin, DI or JB	-----
Paved Ditch Gutter	-----
Storm Sewer Manhole	-----
Storm Sewer	-----

## UTILITIES:

POWER:	
Existing Power Pole	-----
Proposed Power Pole	-----
Existing Joint Use Pole	-----
Proposed Joint Use Pole	-----
Power Manhole	-----
Power Line Tower	-----
Power Transformer	-----
U/G Power Cable Hand Hole	-----
H-Frame Pole	-----
Recorded U/G Power Line	-----
Designated U/G Power Line (S.U.E.*)	-----

## TELEPHONE:

Existing Telephone Pole	-----
Proposed Telephone Pole	-----
Telephone Manhole	-----
Telephone Booth	-----
Telephone Pedestal	-----
Telephone Cell Tower	-----
U/G Telephone Cable Hand Hole	-----
Recorded U/G Telephone Cable	-----
Designated U/G Telephone Cable (S.U.E.*)	-----
Recorded U/G Telephone Conduit	-----
Designated U/G Telephone Conduit (S.U.E.*)	-----
Recorded U/G Fiber Optics Cable	-----
Designated U/G Fiber Optics Cable (S.U.E.*)	-----

## WATER:

Water Manhole	-----
Water Meter	-----
Water Valve	-----
Water Hydrant	-----
Recorded U/G Water Line	-----
Designated U/G Water Line (S.U.E.*)	-----
Above Ground Water Line	-----

## TV:

TV Satellite Dish	-----
TV Pedestal	-----
TV Tower	-----
U/G TV Cable Hand Hole	-----
Recorded U/G TV Cable	-----
Designated U/G TV Cable (S.U.E.*)	-----
Recorded U/G Fiber Optic Cable	-----
Designated U/G Fiber Optic Cable (S.U.E.*)	-----

## GAS:

Gas Valve	-----
Gas Meter	-----
Recorded U/G Gas Line	-----
Designated U/G Gas Line (S.U.E.*)	-----
Above Ground Gas Line	-----

## SANITARY SEWER:

Sanitary Sewer Manhole	-----
Sanitary Sewer Cleanout	-----
U/G Sanitary Sewer Line	-----
Above Ground Sanitary Sewer	-----
Recorded SS Forced Main Line	-----
Designated SS Forced Main Line (S.U.E.*)	-----

## MISCELLANEOUS:

Utility Pole	-----
Utility Pole with Base	-----
Utility Located Object	-----
Utility Traffic Signal Box	-----
Utility Unknown U/G Line	-----
U/G Tank; Water, Gas, Oil	-----
Underground Storage Tank, Approx. Loc.	-----
AG Tank; Water, Gas, Oil	-----
Geoenvironmental Boring	-----
U/G Test Hole (S.U.E.*)	-----
Abandoned According to Utility Records	-----
End of Information	-----

PROJECT NO.	SHEET NO.	TOTAL NO.
43574.3.1 (SS-4908AI), 45338.3.FS10 (W-5208J), 50138.3.FS7 (W-5601I)	3	

### SUMMARY OF QUANTITIES

PROJECT NO	COUNTY	MAP NO	ROUTE	DESCRIPTION	TYP	LANES	LANE TYPE	FINAL SURFACE TESTING REQUIRED	WARM MIX ASPHALT REQUIRED	LENGTH MI	WIDTH FT	GRADING LS	FOUNDATION CONDITIONING MATERIAL, MINOR STRUCTURES TON	FOUNDATION CONDITIONING GEOTEXTILE SY	24" RC PIPE CULVERT, CLASS III LF	15" RC PIPE CULVERT, CLASS IV LF	18" RC PIPE CULVERT, CLASS IV LF	PIPE REMOVAL LF	INCIDENTAL STONE BASE TON	0" TO 1.5" MILLING SY	BASE COURSE, B25.0B TON	INTERMEDIATE COURSE, I19.0B TON	SURFACE COURSE, S9.5B TON	ASPHALT BINDER FOR PLANT MIX TON	AC PLANT MIX (REPAIR) TON	PIPE COLLAR CY	MASONRY DRAINAGE STRUCTURE EA
43574.3.1 (SS-4908AI)	Hoke	1	US 401	DIRECTIONAL LEFTOVER AT SR 1304 (HOBSON RD) WITH BULBOUT	1-11	2	MD	NO	NO	0.37	24	0.29	62	195		224	354	23	50	560	1,170	600	710	123	25		4
TOTAL FOR MAP NO. 1										0.37		0.29	62	195		224	354	23	50	560	1,170	600	710	123	25		4
TOTAL FOR PROJ NO. 43574.3.1 (SS-4908AI)										0.37		0.29	62	195		224	354	23	50	560	1,170	600	710	123	25		4
45338.3.FS10 (W-5208J)	Hoke	2	US 401	INTERSECTIONS IMPROVEMENTS AT SR 1305 (WAYSIDE RD) AND SR 1418 (LINDSAY RD)	1-26	2	MD	NO	NO	0.93	24	0.62	140	435	4	750	542	90	50	900	2,835	1,450	1,745	299	80	0.9516	6
TOTAL FOR MAP NO. 2										0.93		0.62	140	435	4	750	542	90	50	900	2,835	1,450	1,745	299	80	0.9516	6
TOTAL FOR PROJ NO. 45338.3.FS10 (W-5208J)										0.93		0.62	140	435	4	750	542	90	50	900	2,835	1,450	1,745	299	80	0.9516	6
50138.3.FS7 (W-5601I)	Hoke	3	US 401	AT INTERSECTION WITH SR 1405 (N. MAIN ST)	1-2	2	MD	NO	NO	0.01	24	0.09						34		400	55	70	40	8	25		1
TOTAL FOR MAP NO. 3										0.01		0.09						34		400	55	70	40	8	25		1
TOTAL FOR PROJ NO. 50138.3.FS7 (W-5601I)										0.01		0.09						34		400	55	70	40	8	25		1
GRAND TOTAL										1.31		1.00	202	630	4	974	896	147	100	1,860	4,060	2,120	2,495	430	130	0.9516	11

PROJECT NO	COUNTY	MAP NO	ROUTE	DESCRIPTION	TYP	LANES	LANE TYPE	FINAL SURFACE TESTING REQUIRED	WARM MIX ASPHALT REQUIRED	LENGTH MI	WIDTH FT	FRAME WITH TWO GRATES, STD 840.16 EA	FRAME WITH TWO GRATES, STD 840.22 EA	FRAME WITH MH COVER, STD 840.54 EA	CONCRETE TRANSITIONAL SECTION FOR DROP INLET EA	5" MONOLITHIC CONCRETE ISLANDS (SURFACE MOUNTED) SY	ADJUST DROP INLET EA	ADJUST MANHOLES EA	ADJUST METER OR VALVE BOX EA	RIP RAP, CLASS B TON	GEOTEXTILE FOR DRAINAGE SY	PORTABLE LIGHTING LS	8" WATER LINE LF	TEMPORARY SILT FENCE LF	EROSION CONTROL STONE, CLASS A TON	EROSION CONTROL STONE, CLASS B TON	SEDIMENT CONTROL STONE TON
43574.3.1 (SS-4908AI)	Hoke	1	US 401	DIRECTIONAL LEFTOVER AT SR 1304 (HOBSON RD) WITH BULBOUT	1-11	2	MD	NO	NO	0.37	24		3	1		470		1		5	17				15	35	50
TOTAL FOR MAP NO. 1										0.37			3	1		470		1		5	17				15	35	50
TOTAL FOR PROJ NO. 43574.3.1 (SS-4908AI)										0.37			3	1		470		1		5	17				15	35	50
45338.3.FS10 (W-5208J)	Hoke	2	US 401	INTERSECTIONS IMPROVEMENTS AT SR 1305 (WAYSIDE RD) AND SR 1418 (LINDSAY RD)	1-26	2	MD	NO	NO	0.93	24	2	4		2	2,945	5	1	1	14	45	1	60	825	20	10	75
TOTAL FOR MAP NO. 2										0.93		2	4		2	2,945	5	1	1	14	45	1	60	825	20	10	75
TOTAL FOR PROJ NO. 45338.3.FS10 (W-5208J)										0.93		2	4		2	2,945	5	1	1	14	45	1	60	825	20	10	75
50138.3.FS7 (W-5601I)	Hoke	3	US 401	AT INTERSECTION WITH SR 1405 (N. MAIN ST)	1-2	2	MD	NO	NO	0.01	24	1			1	88								430	6	8	6
TOTAL FOR MAP NO. 3										0.01		1			1	88								430	6	8	6
TOTAL FOR PROJ NO. 50138.3.FS7 (W-5601I)										0.01		1			1	88								430	6	8	6
GRAND TOTAL										1.31		3	7	1	3	3,503	5	2	1	19	62	1	60	1,255	41	53	131

PROJECT NO	COUNTY	MAP NO	ROUTE	DESCRIPTION	TYP	LANES	LANE TYPE	FINAL SURFACE TESTING REQUIRED	WARM MIX ASPHALT REQUIRED	LENGTH MI	WIDTH FT	TEMPORARY MULCHING ACR	MATting (EROSION CONTROL) SY	PERMANENT SOIL REINFORCEMENT MAT SY	1/4" HARDWARE CLOTH LF	WATTLE LF	POLYACRYLAMIDE (PAM) LB	COIR FIBER BAFFLES LF	SEED & MULCHING AC	SEED FOR REPAIR SEEDING LB	FERTILIZER FOR REPAIR SEEDING TON	SIGNAL CABLE LF	VEHICLE SIGNAL HEAD (12", 3 SECTION) EA	BORE & JACK (1 CONDUIT, 2 INCH) LF	UNPAVED TRENCHING (1 CONDUIT, 2") LF	JUNCTION BOX (STANDARD SIZE) EA	INDUCTIVE LOOP SAWCUT LF	LEAD-IN CABLE (14-2 PAIR) LF	SIGN FOR SIGNALS EA
43574.3.1 (SS-4908AI)	Hoke	1	US 401	DIRECTIONAL LEFTOVER AT SR 1304 (HOBSON RD) WITH BULBOUT	1-11	2	MD	NO	NO	0.37	24	1.25	1,100	435	80	705	5	45	1.25	50	0.25								
TOTAL FOR MAP NO. 1										0.37		1.25	1,100	435	80	705	5	45	1.25	50	0.25								
TOTAL FOR PROJ NO. 43574.3.1 (SS-4908AI)										0.37		1.25	1,100	435	80	705	5	45	1.25	50	0.25								
45338.3.FS10 (W-5208J)	Hoke	2	US 401	INTERSECTIONS IMPROVEMENTS AT SR 1305 (WAYSIDE RD) AND SR 1418 (LINDSAY RD)	1-26	2	MD	NO	NO	0.93	24	2.82	4,150		230	705	15	20	2.82	50	0.25	300	1	75	1,400	7	850	4,100	13
TOTAL FOR MAP NO. 2										0.93		2.82	4,150		230	705	15	20	2.82	50	0.25	300	1	75	1,400	7	850	4,100	13
TOTAL FOR PROJ NO. 45338.3.FS10 (W-5208J)										0.93		2.82	4,150		230	705	15	20	2.82	50	0.25	300	1	75	1,400	7	850	4,100	13
50138.3.FS7 (W-5601I)	Hoke	3	US 401	AT INTERSECTION WITH SR 1405 (N. MAIN ST)	1-2	2	MD	NO	NO	0.01	24				30	5			0.40	50	0.25								
TOTAL FOR MAP NO. 3										0.01					30	5			0.40	50	0.25								
TOTAL FOR PROJ NO. 50138.3.FS7 (W-5601I)										0.01					30	5			0.40	50	0.25								
GRAND TOTAL										1.31		4.07	5,250	435	310	1,440	25	65	4.47	150	0.75	300	1	75	1,400	7	850	4,100	13

